



43 Jessie Street Preston VIC

 4
  1
  2

Another BISI Property GONE At Auction...

\$ 1,325,000

High & Mighty Classic With The Perfect Family Plan...

Type : House
Land Size : 545 sqm
View : <https://www.thebisiagent.com.au/sale/vic/north/preston/residential/house/7138134>

In this exceptionally privileged prestige locality, set amongst the area's finest homes and advantaged for its peaceful outlook over Margaret Walker Reserve & HP Zwar Park opposite, is this much-loved solid brick Victorian. Set on a substantial elevated allotment of 545m², this home offers excellent opportunities for enhancing or developing (STCA).

Vast proportions and a generous floor plan are hallmarks of this tightly held and highly regarded residence. The home also showcases 4 bedrooms, formal lounge room, comfortable bathroom, light filled kitchen and informal open plan living/dining area which naturally overlooks and leads into a glorious garden setting. It also includes: Wide side drive for ample off street parking, secure garage, gas cooking, split system heating/cooling & gas space heater, which confirms instant comfort.

John Bisignano
 03 9489 1030

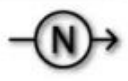
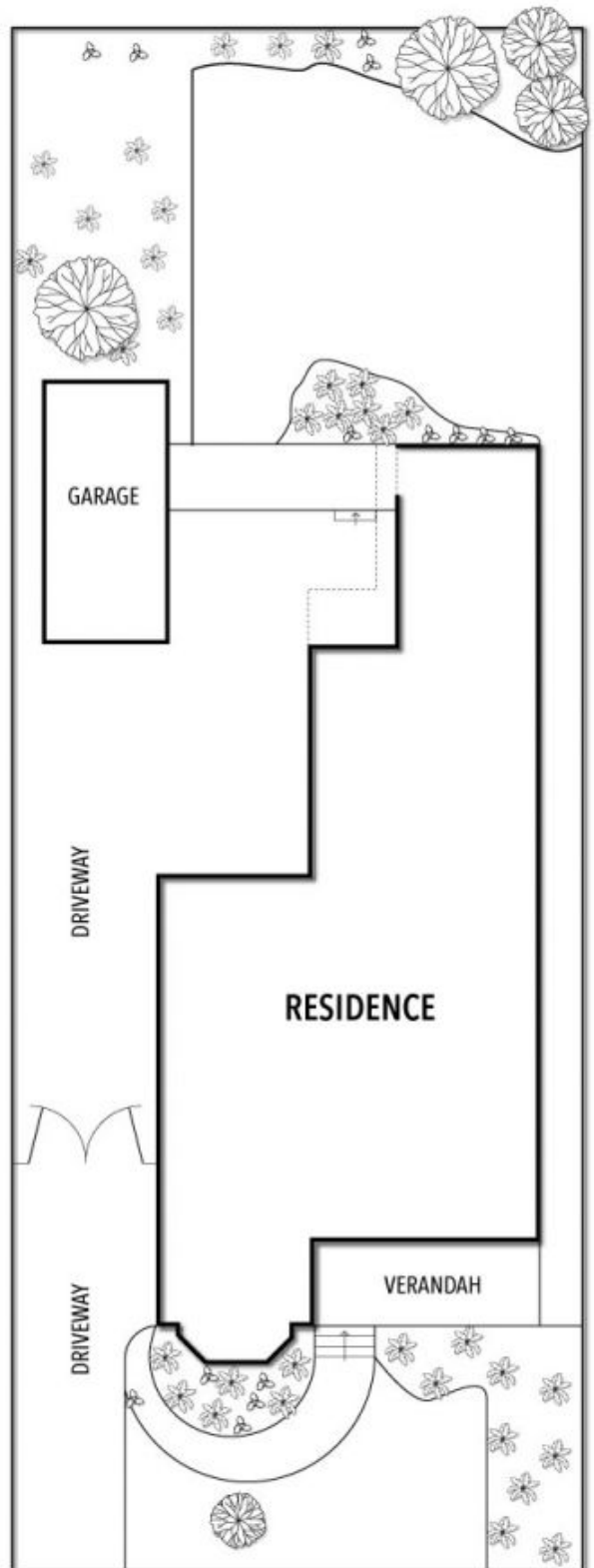

THE ABOVE PLAN IS AN ARTIST'S IMPRESSION ONLY, IT INCLUDES ELEMENTS
 THAT ARE FOR DISPLAY PURPOSES ONLY AND MAY NOT BE TO SCALE.
 LANDSCAPING SHOWN IS INDICATIVE ONLY. DIMENSIONS ARE APPROXIMATE.