

39 Mitchell Street Brunswick VIC

 4  1

More Than Meets The Eye...

Beyond this striking Edwardian facade, is this gorgeous 4 bedroom home, perfectly placed in this super central location with public transport and cafes all just a moment's walk away from evolving Sydney Road.

Set over 2 exciting levels offering a wealth of flexible living choices, the lower level offers a welcoming entrance that proceeds you through a flexible light filled floorplan that offers a optional 2nd living area, well planned kitchen which overlooks open plan living area and leads to the great outdoors for summer entertaining. The lower level also enjoys a designated home office or formal dining area, family bathroom while the upper levels enjoy 2 independent bedroom retreats.

Other loveable & everyday comforts include: Split system heating/cooling, dishwasher, gas cooking, gas heating, good storage, high decorative ceilings, ornate OFPs and hardwood floors throughout.

Type : House
Date Available : Friday, 4th November 2022
View : <https://www.thebisiagent.com.au/lease/vic/north/brunswick/residential/house/7254380>

Northcote Rental Department
 03 9489 1030



GROUND FLOOR

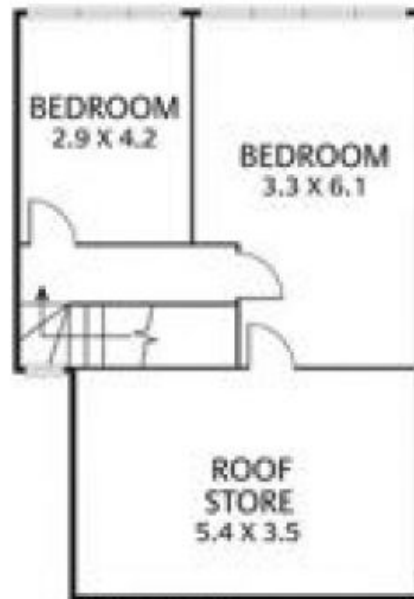

FIRST FLOOR

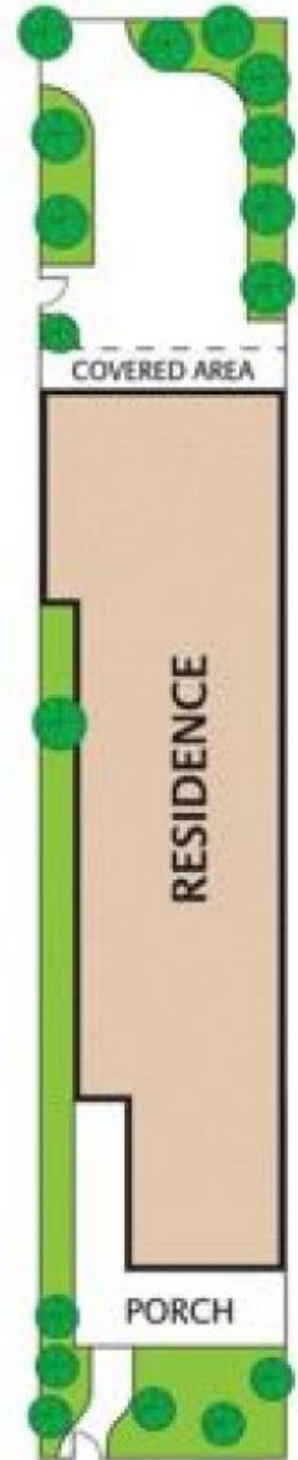

PORCH