



2 Crawley Street Reservoir VIC

4 1 2

**Period Perfect Edwardian With Loads Of Family Promise...**

**\$ 1,380,000**

Situated amongst some of the finest period homes in this tightly held precinct backing onto GE Robinson Park & Tennis Courts, is this substantial Edwardian residence with beautiful character features throughout & offering the perfect recipe for family success on this elevated and leafy deep block measuring 592 m2.

**Type** : House  
**Land Size** : 592 sqm  
**View** : <https://www.thebisiagent.com.au/sale/vic/north/reservoir/residential/house/7370063>

A large sense of space is recognised upon entrance with a long wide hallway & high ceilings which leads you through its naturally light filled layout that offers: 3 generous robed bedrooms, fitted home office or gorgeous nursery or kid's bedrooms, family claw foot bathroom and separate toilet.

The formal living & dining zones are complimented with 2 further open fireplaces, while the comfortable kitchen presents good preparation spaces & ample cabinetry which on looks to the huge North facing rear garden with undercover entertaining, large garden shed and easy side

**John Bisignano**  
 03 9489 1030

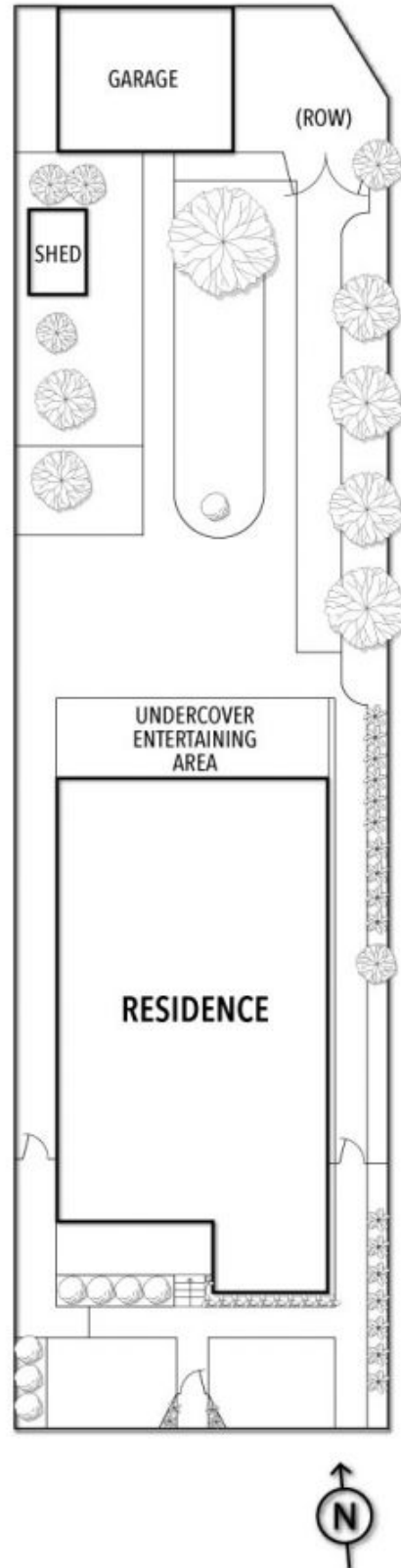
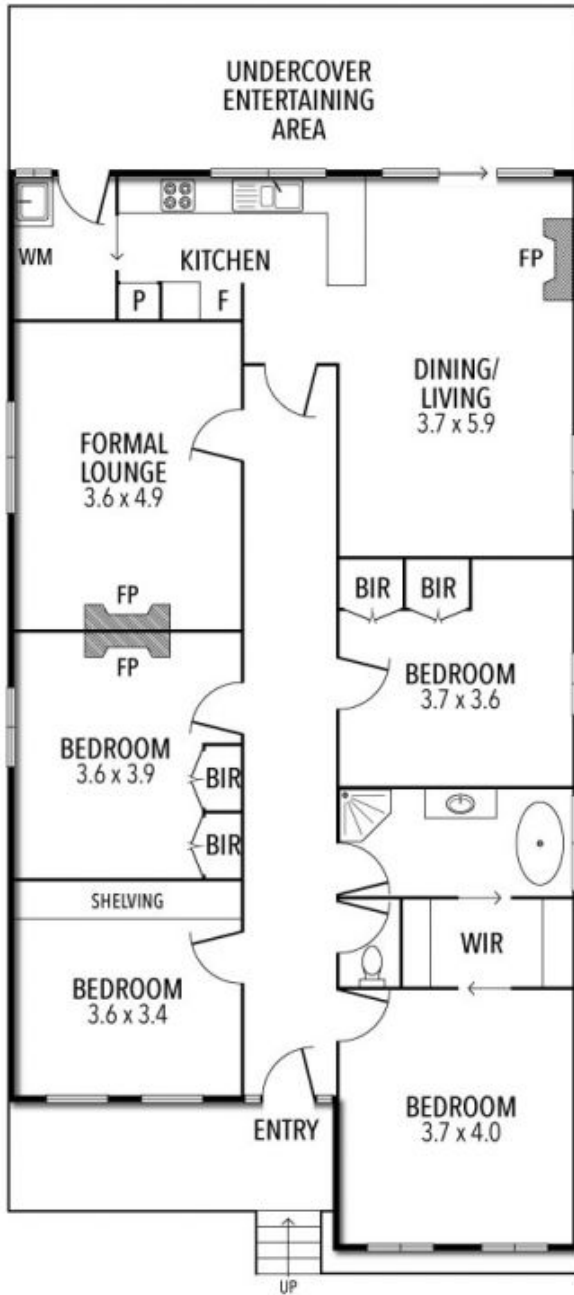
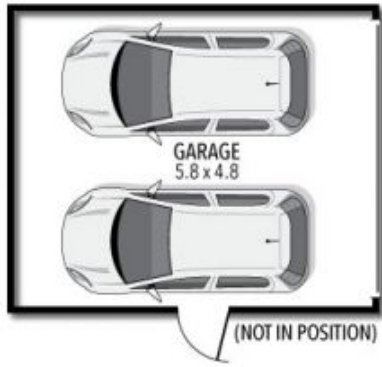

THE ABOVE PLAN IS AN ARTIST'S IMPRESSION ONLY, IT INCLUDES ELEMENTS THAT ARE FOR DISPLAY PURPOSES ONLY AND MAY NOT BE TO SCALE. LANDSCAPING SHOWN IS INDICATIVE ONLY. DIMENSIONS ARE APPROXIMATE.