



805/35 Plenty Road Preston VIC

 2
  1
  1

### You'll Love The Parkland View...

Please Note: This property is currently under offer subject to the buyer meeting a special condition. To be kept updated about this property and upcoming new listings, please email agent.

Triumphant in its ability to blend the creation of space with warmth & intimacy throughout its well-planned layout, this apartment really promises incredible comfort & an easy-care lifestyle, located close to the junction where Thornbury meets Preston with plenty of options for socializing day or night and public transport are also aplenty.

A real joy to live in, its 8th floor Easterly position, boasts about its uninterrupted parkland outlook & natural flow between kitchen, dining and lounge opening outdoors to alfresco undercover entertaining. Both bedrooms also find the need to highlight their parkland outlooks, with 1 enjoying a wider framed vista, which has created the

**Type** : Apartment

**View** : <https://www.thebisiagent.com.au/sale/vic/north/preston/residential/apartment/8008416>

**John Bisignano**  
03 9489 1030

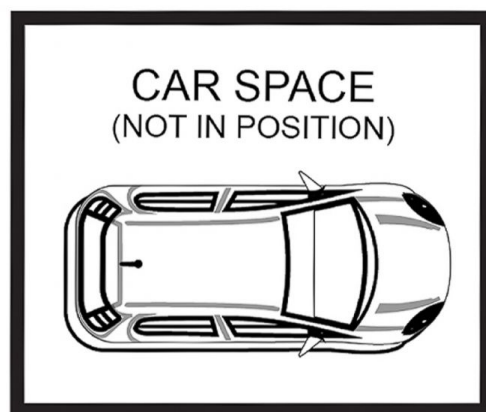
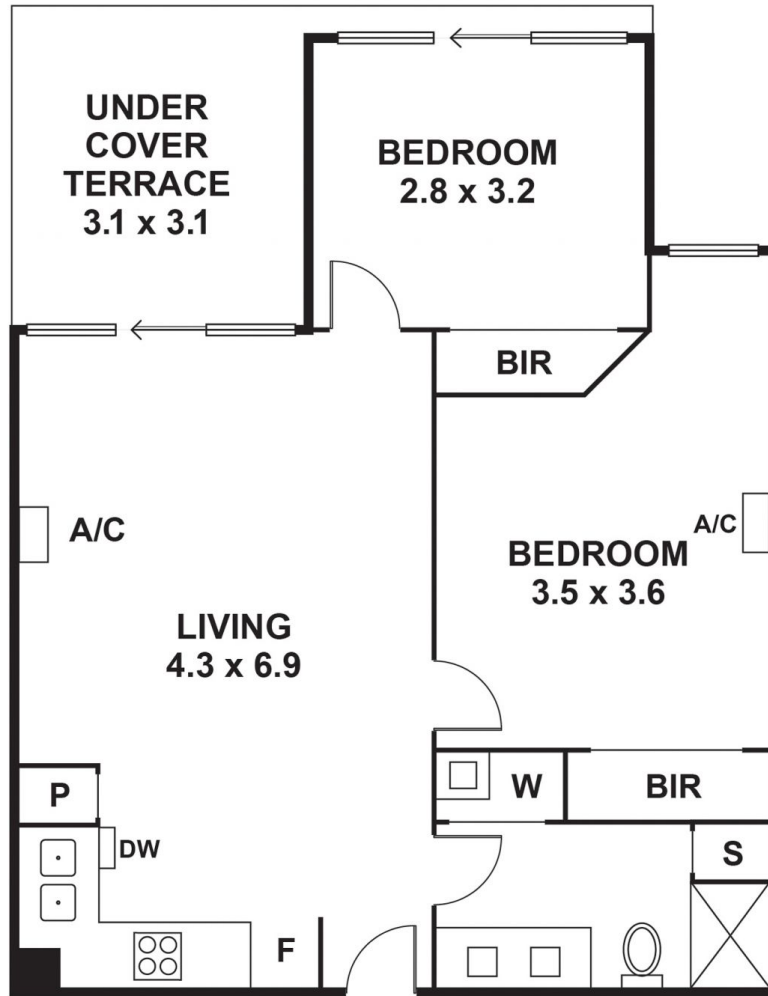

APPROX. INTERNAL AREA: 65 SQM



THE ABOVE PLAN IS AN ARTIST'S IMPRESSION ONLY, IT INCLUDES ELEMENTS THAT ARE FOR DISPLAY PURPOSES ONLY AND MAY NOT BE TO SCALE. LANDSCAPING SHOWN IS INDICATIVE ONLY. DIMENSIONS ARE APPROXIMATE.